

City Of Gainesville

Tent Permit Requirements

TENT CHECKLIST

ALL ITEMS ON THIS CHECKLIST SHALL BE SHOWN IN THE DOCUMENTATION PROVIDED FOR THE TENT PERMIT APPLICATION

1. PLAN MUST SHOW THE SIZE OF THE TENT, INTERIOR LAYOUT, LOCATION OF ALL EXITS, LOCATION OF ALL SUPPORT POLES, AND ANY INTERIOR DISPLAYS, EQUIPMENT, OR FURNISHINGS.
2. ONE or MORE – 2A:10BC EXTINGUISHERS ACCESSIBLE TO OCCUPANTS IN ACCORDANCE WITH NFPA 10.
3. NO SMOKING SIGNS POSTED.
4. ALL TENT ROPES AND STAKES MARKED AND PROTECTED.
5. A MINIMUM OF A 36" ISLE WIDTH SHALL BE MAINTAINED FOR ALL EXITS. (Large tents with high occupant loads must meet the requirements of the Life Safety Code)
6. PLAN MUST SHOW THAT TENT LOCATION IS READILY ACCESSIBLE BY FIRE EQUIPMENT.
7. PLAN MUST SHOW THAT TENT LOCATION DOES NOT OBSTRUCT FIRE EQUIPMENT ACCESS TO EXISTING BUILDINGS.
8. PLAN MUST SHOW THAT TENT LOCATION DOES NOT OBSTRUCT EXIT DISCHARGE FROM EXISTING BUILDINGS.
9. PLAN MUST SHOW TENT LOCATION RELATIVE TO SURROUNDING TENTS, STREETS, AND BUILDINGS.
10. PLAN MUST SHOW VEHICULAR LANE CLEARANCES FOR PROPER TRAFFIC FLOW.
11. ALL WIRING SHALL COMPLY WITH NFPA 70 (2008 NEC).
12. SEPARATE ELECTRICAL PERMIT SHALL BE OBTAINED FOR ALL ASSOCIATED WIRING.
13. TENT FLAME CERTIFICATION MUST MATCH THE TENT BEING INSTALLED.
14. TENT PERMITS FOR OPERATIONS SELLING MERCHANDISE MUST ALSO OBTAIN A PERMIT FROM CODE ENFORCEMENT.

NO STRUCTURE INSTALLED UNDER THIS PERMIT SHALL BE OCCUPIED UNTIL A CERTIFICATE OF COMPLETION HAS BEEN ISSUED. THE CERTIFICATE OF COMPLETION MAY BE OBTAINED FROM THE BUILDING INSPECTION DEPARTMENT.

PLEASE CALL (352) 334-5050 24 HOURS IN ADVANCE FOR AN INSPECTION REQUEST.

TENT SITE PLAN

Dimensions of the tent

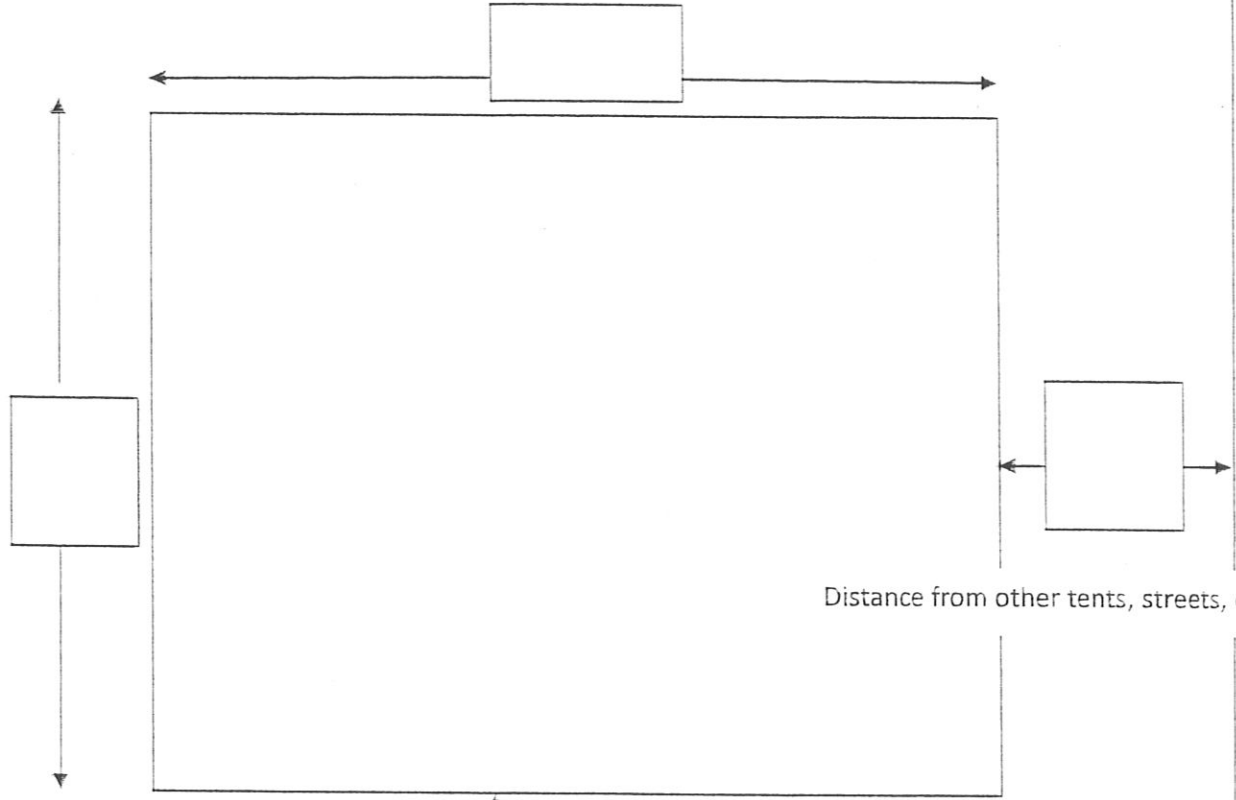

Distance from other tents, streets, or buildings

Distance from street

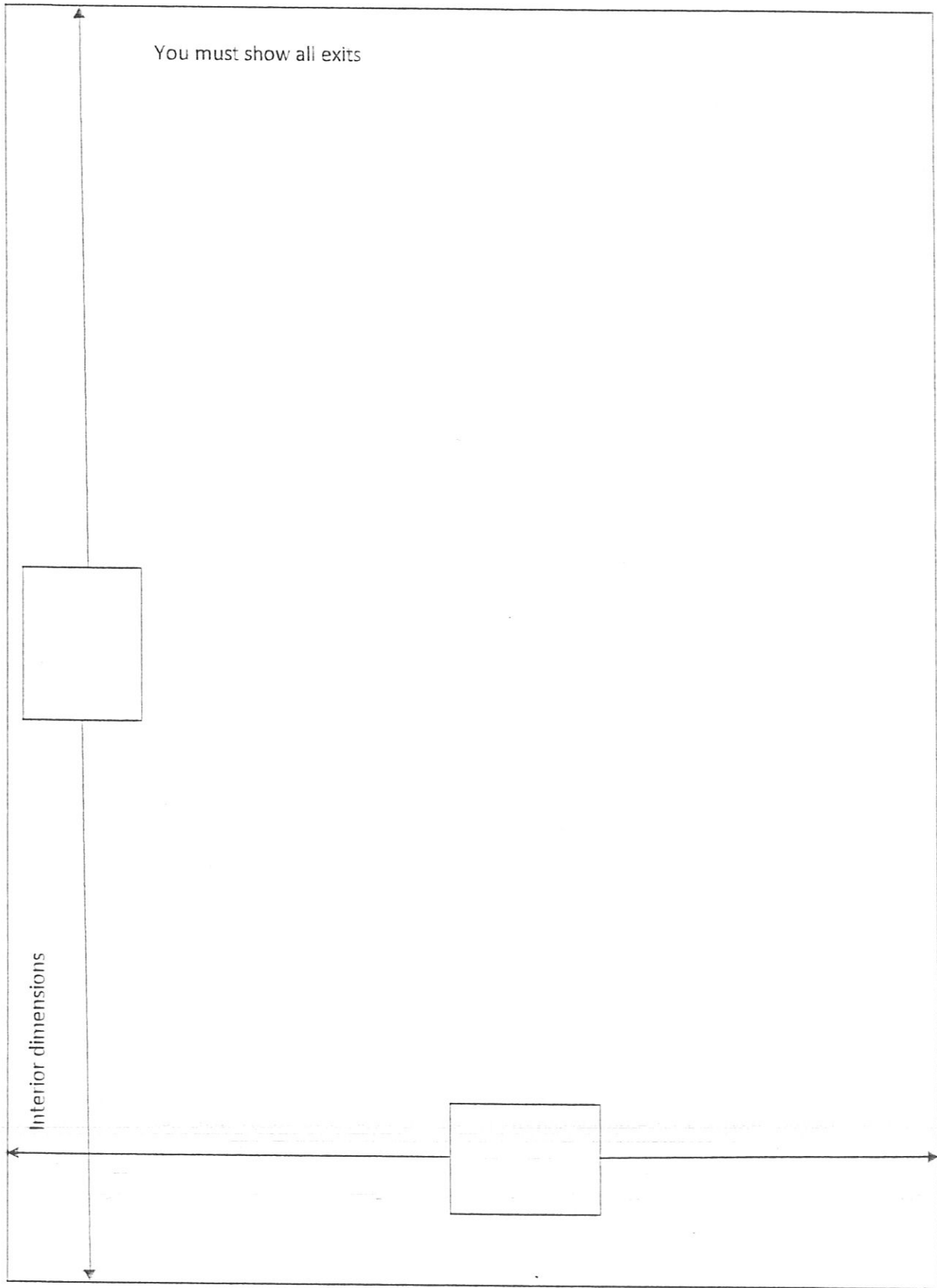

You must show locations of all displays, equipment, tables and chairs, and support poles.
Aisles and Exit widths must be clearly indicated.